





*Making homes affordable
and happiness accessible*



At **Shiv Aangan**, you don't just buy your dream home but you happen to possess a complete package, which immense happiness is an integral part of. Also, the price is as surprising as the kind of living offered here. So, be here and enjoy everything to the fullest be it luxury, comfort or the freedom to live your life the way you want.



The courtyard of contentment

As the name suggests, **Shiv Aangan** has beautifully landscaped open spaces stretched afar within the campus. Also, the open spaces are dotted with a number of water bodies, giving the campus an exquisite look. Apart from ample greenery and open spaces, **Shiv Aangan** is grand in terms of its campus area too as it is spread across the area of 10 acres. The campus has a total number of 499 flats ranging from 2 and 3 to 4 BHK. So, be here and own your choicest place; and of course your choicest way of life too.



Club
Aangan



Having fun was never this easy

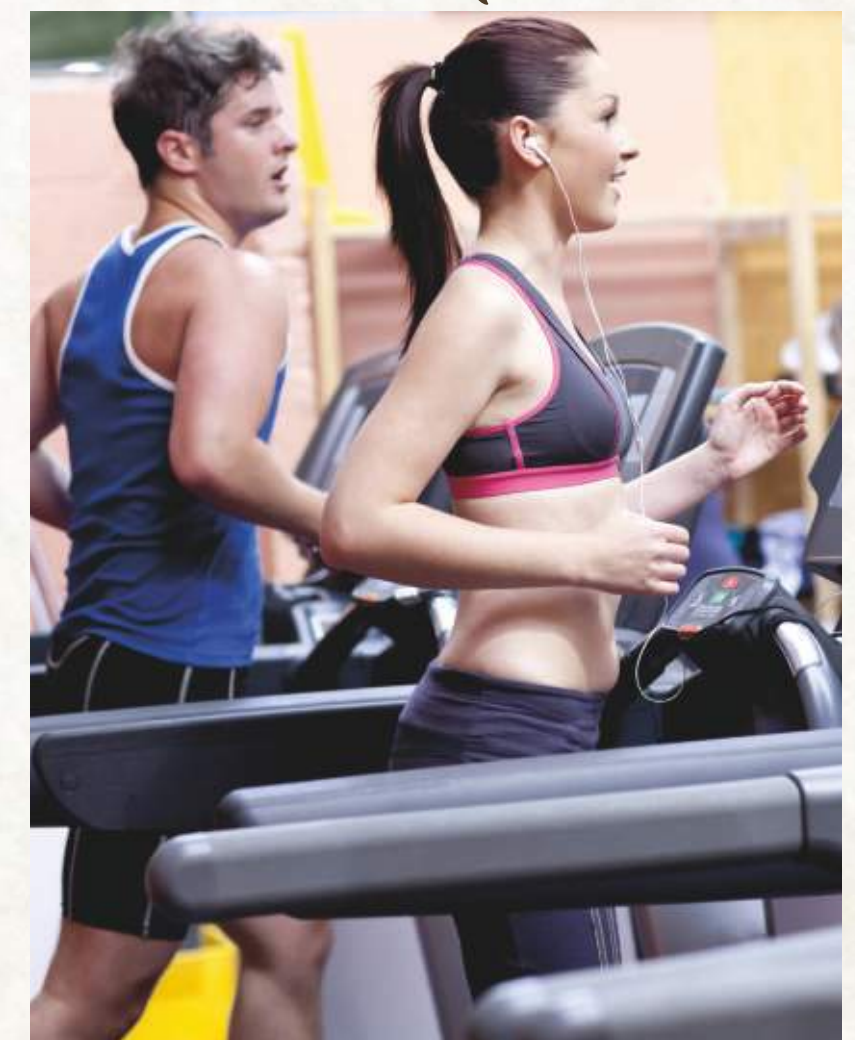

Have fun to the fullest and live your life to the max. At **Shiv Aangan**, having a joyous retreat is not a matter of chance, you can experience it very often, even the moment you want. The club and amusement features offered here only assure you a fun-filled lifestyle but also help you overcome your health worries.

Club house

- Attractive swimming pool
- Well-equipped air conditioned gym.
- Furnished guest rooms
- AC kitty party hall
- Indoor games like table tennis, chess, carom board, pool table
- Playroom for kids
- Meditation and yoga center



PROJECT FEATURES

- Grand entrance plaza.
- Covered campus with intercom facility.
- Well-equipped clubhouse.
- Jogging track.
- Cricket pitch with practice net.
- Temple within the campus.
- Flats with proper ventilation.
- Lush green gardens with beautiful landscaping.
- High-tech security system with CCTV cameras.
- Security guards available for 24x7.
- Children play zone with slides, rotor, see-saw and other outdoor play features.
- Street lighting in entire campus.
- Under-ground electrification.
- Reserved car parking space.
- Well designed rain water harvesting.
- School, college, bank, hospital, mall etc. in close vicinity.
- Power backup for common areas and elevators in each tower.
- Commercial space for daily needs.
- Wide internal roads.
- Sewage treatment plant.



**SHIV
AANGAN**
 2, 3 & 4 BHK PREMIUM LIVING APARTMENTS

Explore the exciting side
of futuristic living spaces



Apart from all modern campus amenities and lifestyle features, **Shiv Aangan** has a lot more to offer which takes its residents to a newer level of futuristic living. It encompasses an in-campus commercial complex cum shopping area ensuring extreme convenience for the inhabitants while they seek an expedient resource to fulfil their day-to-day shopping needs.



Let your desires flourish, let your dreams get fulfilled

For your dreams, there can't be a better reward than this. Perfectly planned, perfectly designed and perfectly constructed, these are a few aspects that make **Shiv Aangan** a perfect place to reside in. It's a campus of 2, 3 & 4 BHK apartments with all the features and amenities you can imagine in your dream home.





PROJECT SPECIFICATIONS

STRUCTURE:-

Earthquake resistant R.C.C. framed structure.

DOORS & WINDOWS:-

Door Frame - Painted Dewas section.

Door Panel - Flush Door with PVC membrane door sheet and center lock.

Window - MS grill powder coated, three track aluminum section.

FLOORINGS:-

Superior quality vitrified tiles of 2'0" x 2'0" size. Anti-skid ceramic tiles in toilet & balcony.

TOILETS:-

Dado in ceramic tiles upto 7'0". White chinaware (Johnson & Johnson / equivalent) with chromium plated fittings (Jaquar / equivalent).

KITCHEN:-

Granite counter with dado of ceramic tiles upto 2' height. Stainless steel sink.

WALLS:-

4" thick walls. Interior walls are plastered and painted with oil bound distemper and exterior walls with Ace / Apex or equivalent brands.

WIRING & CIRCUITS:-

Complete copper wiring. All circuits are protected by MCB's. AC, TV & Telephone point in drawing & all bedrooms.

OUTLETS:-

POP in drawing area. Adequate number of electrical outlets. TV, telephone outlet in drawing room & master bedroom.

4BHK

Block - B6
Builtup Area - 1425.00 sq.ft.
Super Builtup Area - 1897.00 sq.ft.

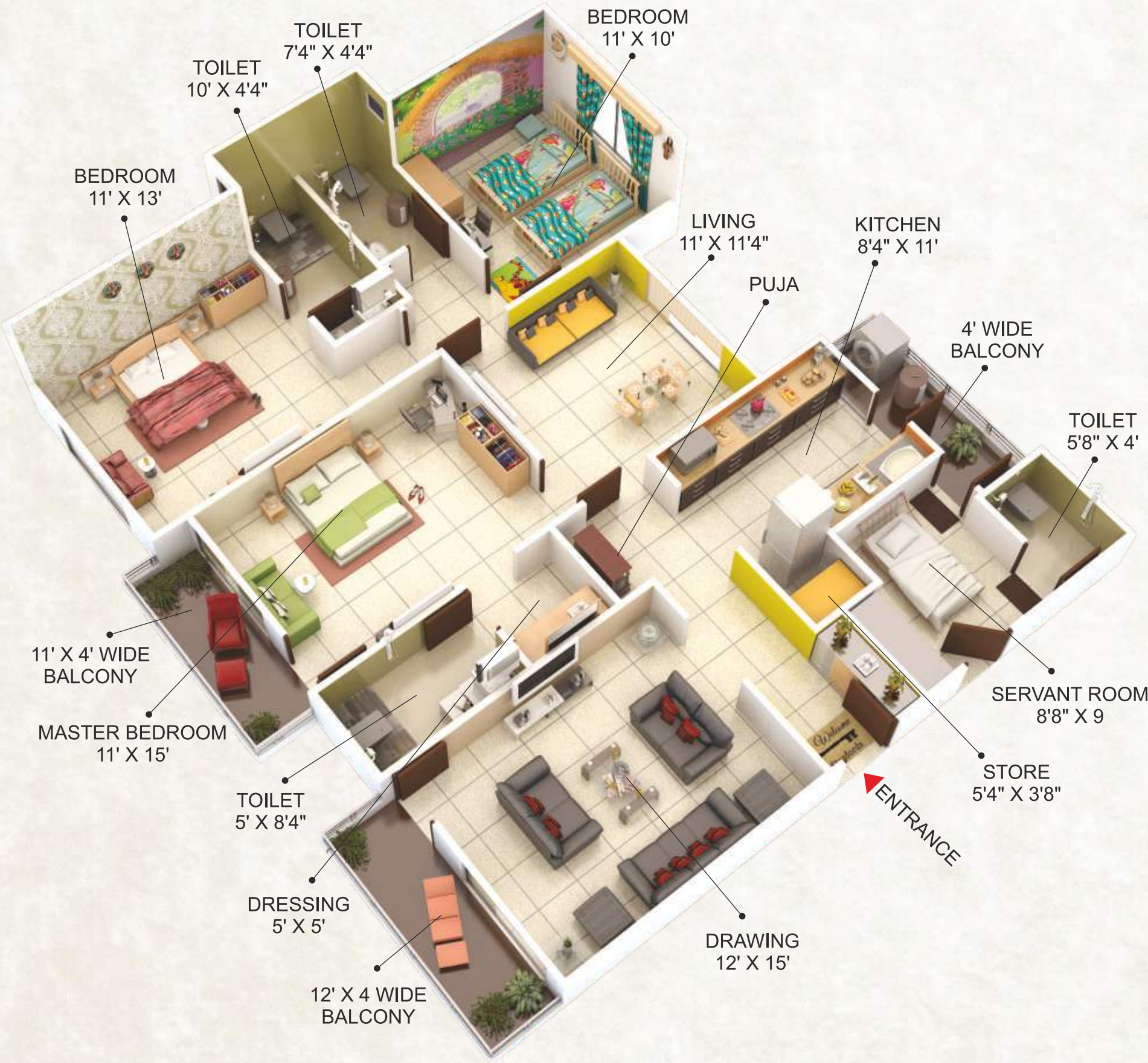

3BHK

Block - I-1, I-2, I-3 & B-7
Builtup Area - 1190.00 sq.ft.
Super Builtup Area - 1590.00 sq.ft.



2BHK (MIG)

Block - B-1, B-2, B-3 & B-4
Builtup Area - 1074.00 sq.ft.
Super Builtup Area - 1419.00 sq.ft.



2BHK (J MIG)

Block - B5
Builtup Area - 562.00 sq.ft.
Super Builtup Area - 730.00 sq.ft.





Prime and precious

The location is truly precious in any way you think about it. Being located at E-8 Extn., Salaiya, Bhopal a prime most residential site is a privilege in itself. Connected to 2 different 80 ft. wide road also assure a trouble-free connectivity from all the key places of the city. Presence of various renowned shopping zones, education institutes, marriage gardens and restaurants add some extra worth to the location.



SHREE SHIV DEVELOPERS

Corporate Office:

1st Floor, Above Andhra Bank, Rohit Nagar,
Bawadia Kalan, E-8 Extn., Bhopal (M.P.)

Site Office:

Opp. BDA Gharonda, Near Aakriti Eco City, E-8, Extension, Salaiya, Bhopal (M.P.)

Call: +91 91111 21177, 91111 21188, 91111 21199

E-mail: enquiry@shreesshivdevelopers.com, shreesshivdevelopers@gmail.com

Website: shreesshivdevelopers.com

Architect

k.d. & Associates

ARCHITECTS, PLANNERS
INTERIOR DESIGNERS
F4, 146, Premium Center, Zone-1,
M.P. Nagar, Bhopal
Ph. (0755) 4252163, 9826082163
e-mail: dixit_kd@yahoo.com

Disclaimer-

This brochure is purely conceptual & not a legal offering. All visual photographs used in this brochure are artists impressions. All specifications, sizes & layout etc. are tentative & subject to such variations, additions, modifications as decided by the Architects or by the Promoters.